

SECTION 5.1.3

REVISION NO.	DATE OF REVISION	REVISION	INITIAL
1.	June/67	Drains Deleted, Added and Changed	
2.	June/68	Drains Added	
3.	April/75	Drain Added	
4.	June/75	Discharge Area Deleted	
5.	85 Oct 28	Boundary and Drains Changed	
6.	86 II 21	Boundary Changed & Drains Added	

241.00 SQ. MI.
624.20 km²

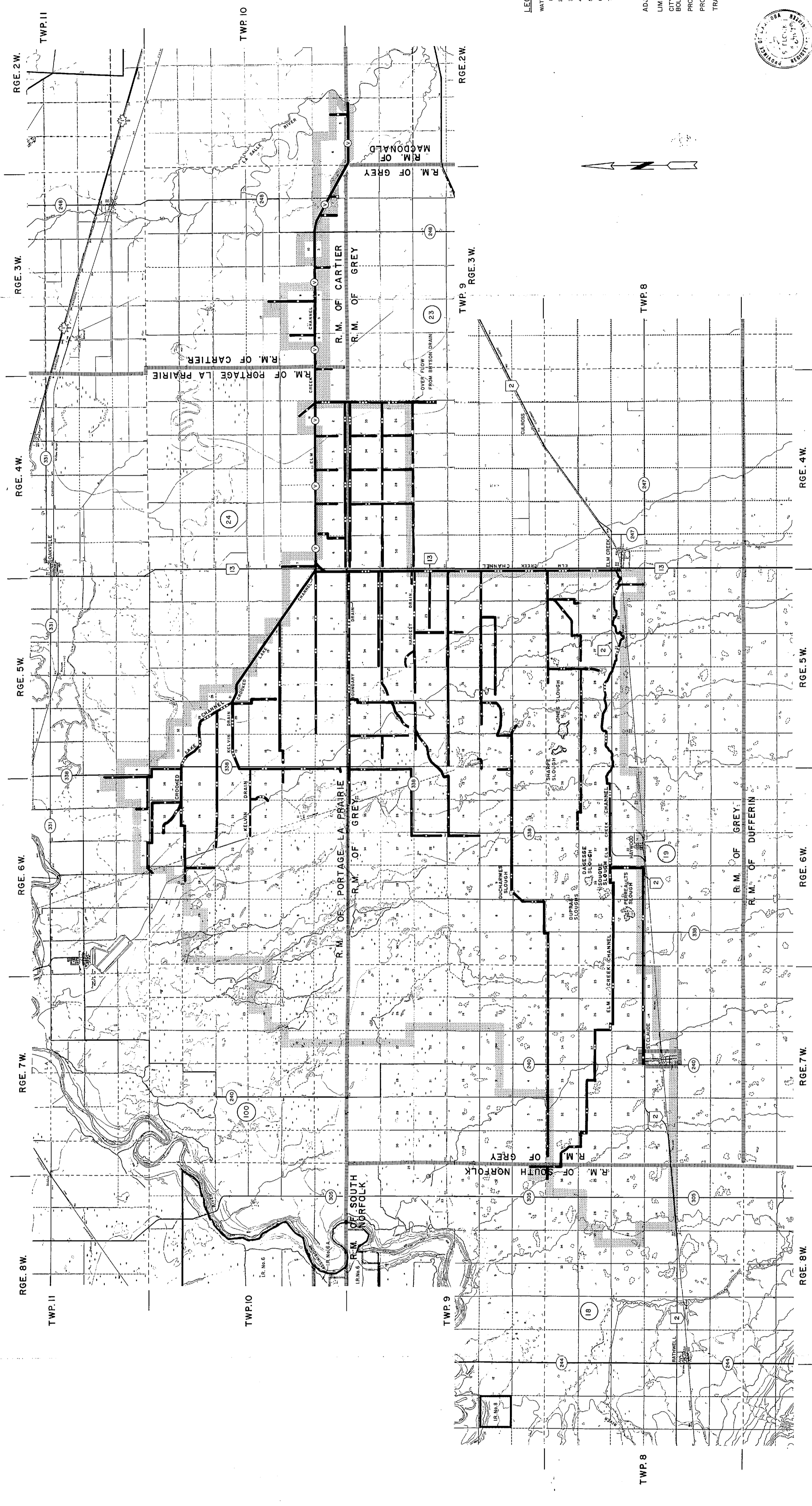

LEGEND

- WATER COURSE
- 1st ORDER DRAINS
- 2nd ORDER DRAINS
- 3rd ORDER DRAINS
- 4th ORDER DRAINS
- 5th ORDER DRAINS
- 6th ORDER DRAINS
- 7th ORDER DRAINS

- ADJACENT WATERSHED
- LIMITS OF DRAINAGE AREA
- CITY, TOWN AND MUNICIPAL BOUNDARIES
- PROVINCIAL TRUNK HIGHWAY
- PROVINCIAL ROADS
- TRANS CANADA HIGHWAY

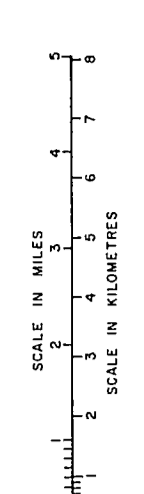

CROSS REFERENCES	REVISIONS	DATE	REMARKS	NAME

APPROVED AS TO:
 DRAWING: R.P. BARTON
 CHECKED BY: J.M. [Signature]
 DRAWN BY: J.M. [Signature]

PROVINCE OF MANITOBA
 DEPARTMENT OF MINES, NATURAL RESOURCES AND ENVIRONMENT
 WATER RESOURCES DIVISION

DESIGNATIONS OF DRAINS
 SHEET NO. 79 06 21
 OF 1
 DATE: 12-5-12 (10)

PLAN OF
 ELM CREEK CHANNEL AREA

AS SHOWN

DIRECTOR, WATER RESOURCES DIVISION

12-5-12 (10)